

KIA ORA WHĀNAU



OUR MISSION//
TO BE DISCIPLES AND
TO MAKE DISCIPLES



SUN 28 APRIL 2019

INSIDE

THE MARRIAGE COURSE
LIVING THE CHANGE
SCHOOL OF THE PROPHETIC
GOD, MONEY & ME

THIS SUNDAY

BEACH CAMPUS//

9 & 11am Judy Bruce
Guest Speaker
7pm James Renwick

PASSAGE FOR THE WEEK:

"So in Christ Jesus you are all children of God through faith, for all of you who were baptised into Christ have clothed yourselves with Christ."
Galatians 3:26-27

WHAKAUPOKO O TE WIKI:

"He tamariki katoa hoki koutou na te Atua, he mea na te whakapono ki a Karaiti Ihu. Ko te hunga katoa hoki o koutou kua iriiria ki roto ki a te Karaiti, kua kakahuria e koutou a te Karaiti." Karatia 3:26-27

BEACH NIGHTS

7pm, Sundays, Beach Campus

We are so excited to have launched a brand new evening service here at Beach! It will be a great time of pressing into God and encountering Him.

THE MARRIAGE COURSE

7pm, Tuesdays, Starting 07 May, Beach Campus, \$60 per couple

A strong, loving and lifelong relationship doesn't happen by chance. It takes effort and dedication to keep the fun and the romance alive. This seven week course is designed to help couples invest in their relationship and build a strong marriage. Register online at grace.org.nz

NEWCOMERS GATHERINGS

TODAY, Welcome Lounge

If you are new to Beach Campus over the last three months or haven't yet been to a welcome event, you are invited to join us for either morning tea at 10.30am or for a pizza lunch at 12.30pm. Here you will meet some of the team and hear a little bit of our vision here at Grace Vineyard Beach Campus. No need to register, just come along!

MARRIAGE PREP COURSE

This five week course looks at communicating effectively, resolving conflict, meeting emotional needs, building a friendship, developing a sexual relationship, and determining roles. It is ideal for engaged couples or those in a committed relationship. \$30 per couple. Starting in June. Email cathy.richardson@grace.org.nz for info.

TOGETHER 19

7pm, Sat 11 May, Christchurch Town Hall

A city-wide church event to stand together; acknowledge grief and loss but also to strengthen, encourage and spur each other on. This will be a significant opportunity to be together as the people of God, and reflect on what it means to be shaped and united by the power of the gospel of Jesus. Tickets available from ticketek.co.nz

LIVE CAMP - WILD

24-26 May, Woodend

LIVE Intermediates Camp is our highlight of the year. We will pursue Jesus together, worship Him, encounter the Holy Spirit, and have lots of fun! Registrations close 13 May so head to grace.org.nz to register today!

ALL SEASONS

1-2.30pm, Wednesdays (during school term), Beach Campus

Starting back this Wednesday for all women, no matter what season you are in. This term's theme is, Getting into Shape - Finding out how God has made you for purpose. Child care is provided and we love it when you bring your babies along!

BEACH CAMPUS PRAYER

Starting back for Term 2 this week, 7-8am, Beach Campus Auditorium.

Tuesdays: Praying for our adult children

Wednesdays: Praying for our Government and the nation

Thursdays: Praying for our Church, Trusts and Community. Everyone welcome!

GIVING AT GRACE

Your money goes a long way. It is used to help those in need, support missionary work and cover operating costs. There are different options to make giving easy!

Internet Banking – Regular Automatic Payments are our preferred option
Account: 06-0821-0579769-000
Code: Your giving number
Reference: Type of giving (eg Tithe)

Pushpay App - Available at the Apple App Store or Google Play Store

Eftpos or Credit Card - Available at Info Desk

Website - You can make donations through here at any time

Cash or Cheque - Pick up an envelope from the Info Desk, write your giving number on it and hand in to the Info Desk or Offering

Light of the World - Please seek God for what He would have you give beyond your tithe. Please code any donation as 'BuildingFund'.

In order to receive a Tax Receipt at the end of the financial year contact us for a Giving Number at giving@grace.org.nz or fill in a Giving Form at the Info Desk.

General giving qualifies for a donations receipt and includes Faith Promise, BuildingFund and other ministries within the church.

Thank you for your generosity!

SCHOOL OF THE PROPHETIC

7-9pm, Starting Tues 14 May, City Campus

A course providing teaching and training in the gift of prophecy. Learn the Biblical basis for prophecy and the importance of relationship with God to prophesy well. Prophecy will be modeled and there will be opportunity to practice, make mistakes, and receive support and feedback. \$20 per person. Register online at grace.org.nz

MISSIONS MONTH

In all of its different expressions, mission is a significant part of the Kingdom of God! In May we'll be exploring what that means for every one of us, and hearing from local and guest speakers! We also have some exciting events planned including an international food festival and a huge night of worship and prayer. Make sure to get along every Sunday during May to support our vision of reaching the nations for Christ!

SCHOOL OF WORSHIP

27-29 June, City Campus

The School of Worship is designed to equip worshippers with the theological, practical and personal skills required to play and lead worship effectively. In its fifth year running, the school has seen numerous worshippers from across New Zealand released to lead their congregations in vibrant worship. Go to gracevineyardmusic.com for more info and to register.

FATHER SON CAMP TEEN EDITION

17-19 May, \$120 per father son pair

A great opportunity for you and your teenage son to get away and spend some time together. The weekend is made up of activities, lots of food, plenty of chill time and a few sessions to help you build on your relationship. For more info and to register, head to youthalivetrust.org.nz/camps/tfsc/ or email matt.barnes@yat.org.nz

LIVING THE CHANGE FILM SCREENING

7.30pm Fri 10 May, City Campus, Unit 5

Creation Care is hosting another free film night! Come along to watch *Living the Change* which shows real New Zealanders making a difference in their contexts. The film features Waveney Warth who spoke at Beach Campus last year. There will be hot chocolate, popcorn, and opportunities to connect with others in our community!

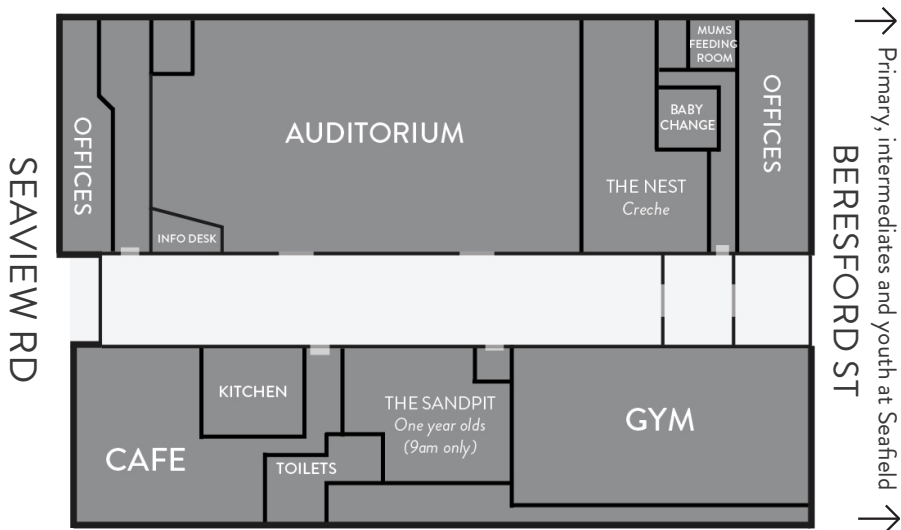

I'M NEW

We'd love to meet you! We have programs for 1 year olds (9am only), 2-3 year olds in rooms close by, and Primary, for age 4-10. Intermediates and Youth are at the Seafield building across Beresford Rd. All kids under 11 must be signed into their programs. Our crew will help direct you! We would love to meet you in our Welcome Lounge after our service. Here you will be able to get a barista coffee, morning tea and meet some of our team. Our next 'Welcome Lunch' will be at 12.30pm, Sun 19 May in the Beach Cafe.

MUMS' FEEDING ROOM

Down the corridor opposite the gym

LITTLE ONES (1 YEAR OLDS)

Parents please take your kids to the Sandpits (9am only)

PRESCHOOL (AGES 2-3)

Parents please take your kids to the Nest

PRIMARY

Parents please take your kids to Seafield across the road

INTERMEDIATES (YEAR 7&8)

Meet the leaders in the foyer

GVY (YEARS 9+)

Meet the leaders in the foyer

GOD
Money
& **ME**

GOD, MONEY & ME //

In term two some of our Lifegroups will be going through the teaching series God, Money & Me. This series is all about stewardship and includes some great keys around how to serve God with our money as well as leaving a legacy for our families. If you would like to lead or join a group for this five week journey, fill out a Connect card or email lifegroups@grace.org.nz

CITY CAMPUS//

150 Ferry Road
Phillipstown
PO Box 12-006
Christchurch 8242
New Zealand
Phone +64 3 379 8463
city.office@grace.org.nz

BEACH CAMPUS//

111 Seaview Road
New Brighton
PO Box 12-006
Christchurch 8242
New Zealand
Phone +64 3 388 5459
beach.office@grace.org.nz

PLAINS CAMPUS//

Rangiora Borough Hall
157 King Street
PO Box 12-006
Christchurch 8242
New Zealand
Phone +64 3 379 8463
plains.office@grace.org.nz

PEGASUS CAMPUS//

Pegasus School Hall
5 Solander Road
PO Box 12-006
Christchurch 8242
New Zealand
Phone +64 3 379 8463
plains.office@grace.org.nz

WEST CAMPUS//

Wigram Primary School
5 The Runway
PO Box 12-006
Christchurch 8242
New Zealand
Phone +64 3 379 8463
west.campus@grace.org.nz